

TEM 035G, TEM 050G
Kunststoffgehäuse

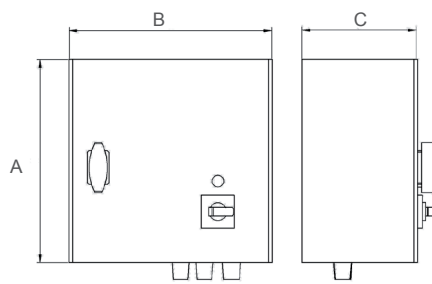

TEM 075G, TEM 100G, TEM 130G
Metallgehäuse



Teile ID	I_{max} [A]	Sicherung [A]	Gewicht [kg]	A [mm]	B [mm]	C [mm]	D [mm]	E [mm]	
TEM 035G	111580	03,5	05,0	04,9	255	170	140	155	194
TEM 050G	109966	05,0	08,0	05,6	255	170	140	155	194
TEM 075G	109988	07,5	12,5	08,7	305	200	140	183	236
TEM 100G	109069	10,0	16,0	14,3	325	300	185	255	255
TEM 130G	111581	13,0	18,0	16,6	325	300	185	255	255

- 230 V ~, 50/60 Hz
- Mit Motorschutz
- Kontakt für Gasmagnetventil
- Aufputzmontage
- IP 54
- Max. Umgebungstemperatur 35 °C

	Ausgangsspannungen U_A [V]				
	1	2	3	4	5
TEM 035G	110	140	170	200	230
TEM 050G	110	140	170	200	230
TEM 075G	110	140	170	200	230
TEM 100G	110	140	170	200	230
TEM 130G	110	140	170	200	230

Montage:

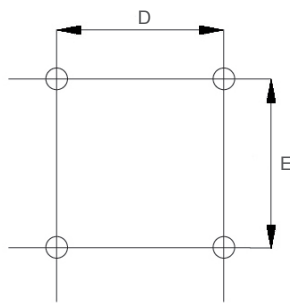

Schaltplan:

